

ALPHA800- APP

**Operating
Instructions**

STEP 1 Download APP

You can directly download and search for "ADELOT" in the IOS APP STORE \GOOGLE PLAY, or use your browser to scan the QR code to download and install.

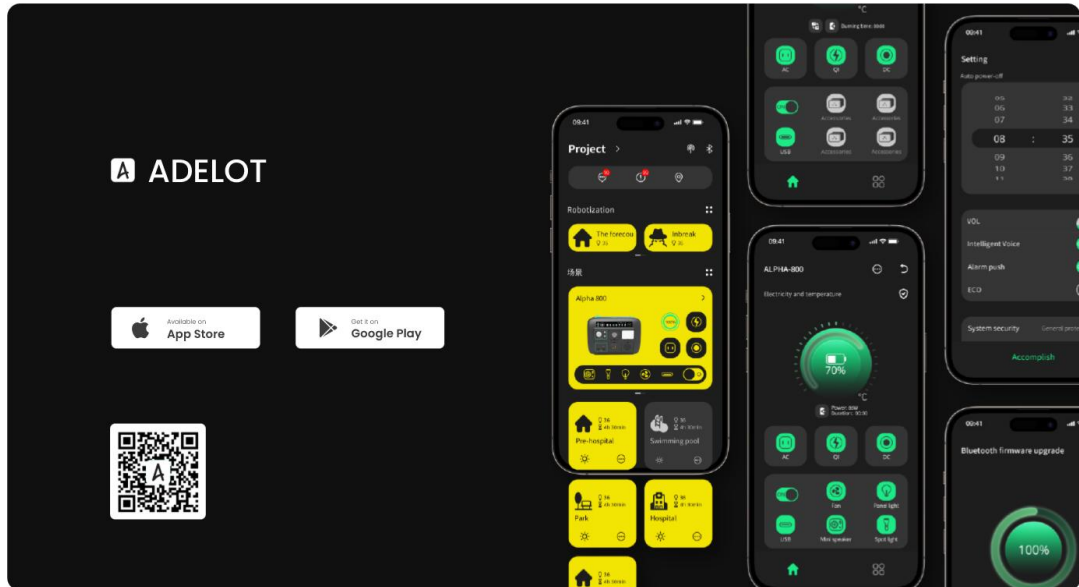

STEP 2 Register Account

Open the APP on your phone, you can select language①,register account②,retrieve password③. New users please register through②old users can directly login with account and password.

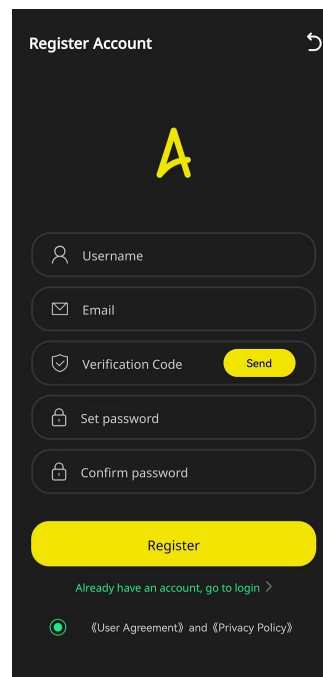
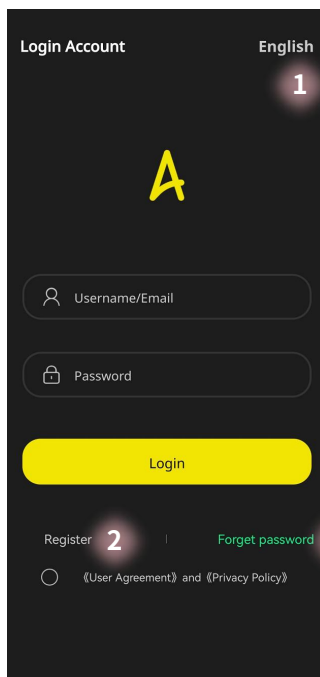

STEP 3 Change Project Name

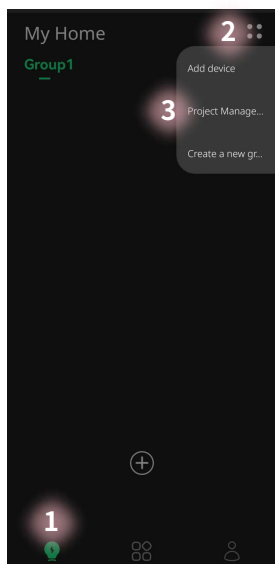

- 1 Select Devices Page
- 2 Click
- 3 Select Project Management

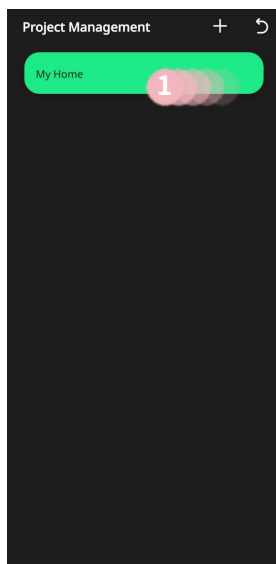

- 1 Swipe From Right to Left

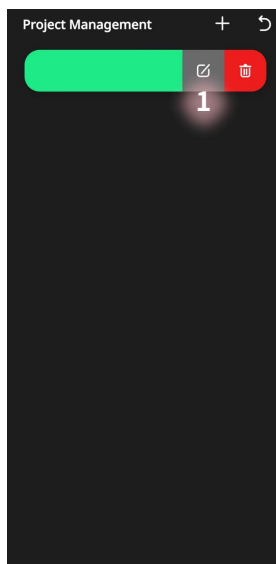

- 1 Click the icon

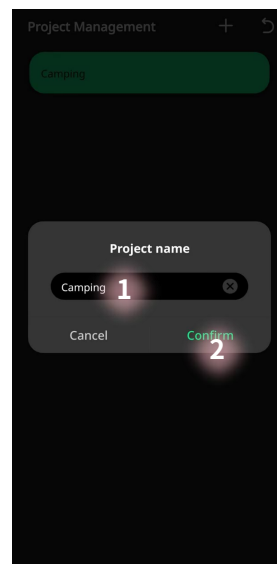

- 1 Click Change Project Name
- 2 Confirm

STEP 4 Search and Add Device

Turn on the ALPHA800 device, and make sure the device is within 10 meters of the phone, while the phone's Bluetooth is turned on.

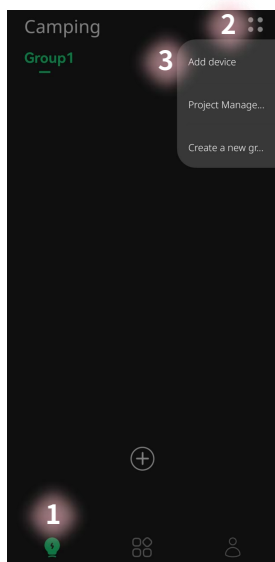

- 1 Select Devices Page
- 2 Click
- 3 Select Add Device

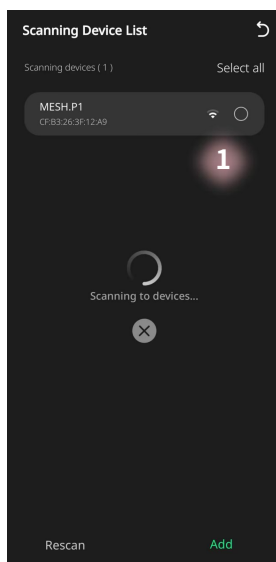

- 1 Auto Search Device

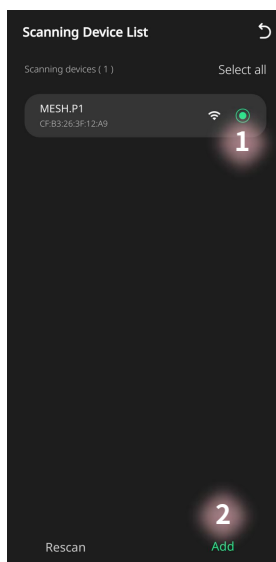

- 1 Select The Device to Add
- 2 Add

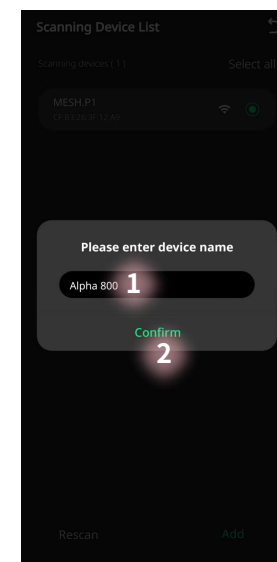

- 1 Change Device Name
- 2 Confirm

*If the device is not found, press and hold the ALPHA800 power button for over 7 seconds to automatically restore the device to factory settings.

STEP 5 APP Control ALPHA800

Method 1

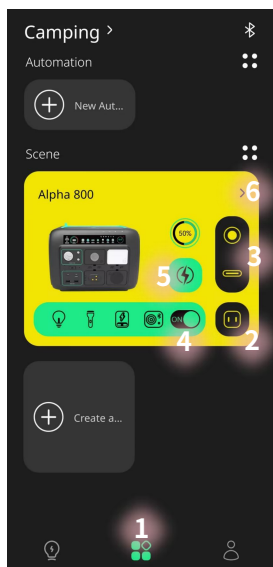

- ① Select Scenes page
- ② AC Output On/Off
- ③ DC Output On/Off
- ④ Accessories
- ⑤ Wireless Charging On/Off
- ⑥ Enter Details Page



- ① Control Each Output Port and Display Information
- ② Display Battery Information
- ③ Display Safety Information
- ④ Device Details

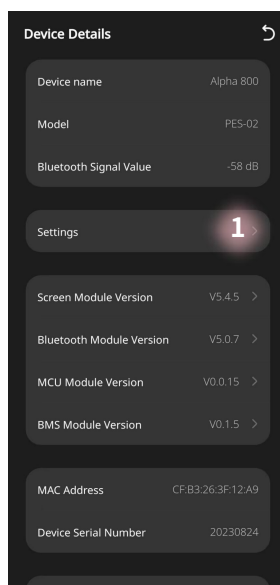

- ① Click Settings to Enter

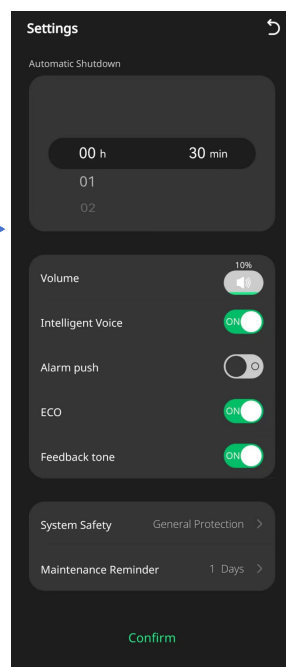

- ① Adjust Settings for Volume, Maintenance Cycles, and Other Parameters
- ② Confirm

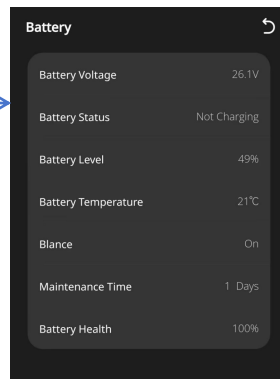
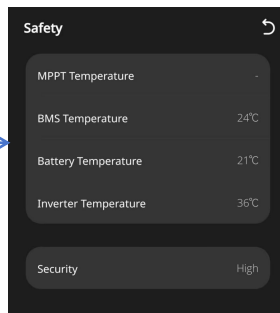

Method 2

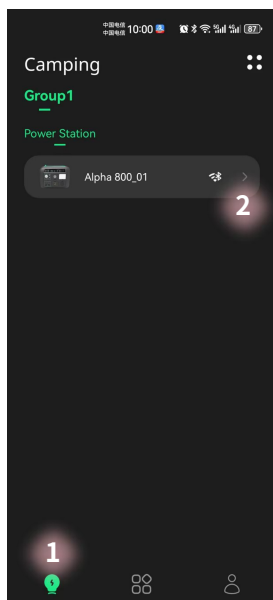

- ① 选择设备界面
- ② 进入详细页面

Others

Rename or Delete The Device

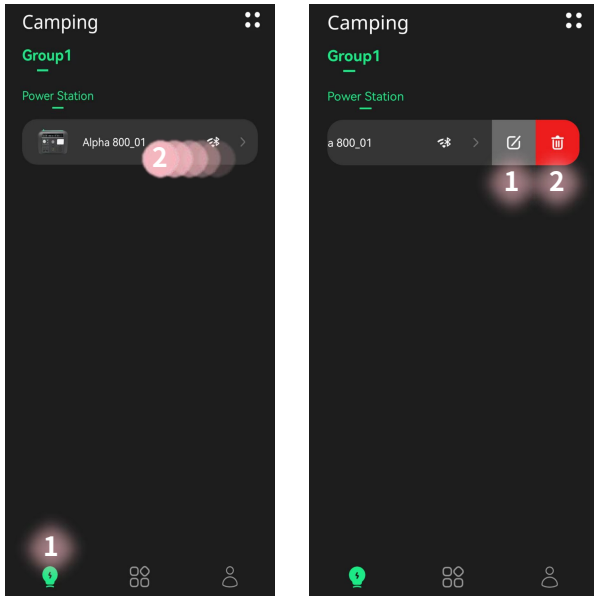

- ① Select Devices Page
- ② Swipe From Right to Left
- ① Rename
- ② Delete The Device

Change APP Language

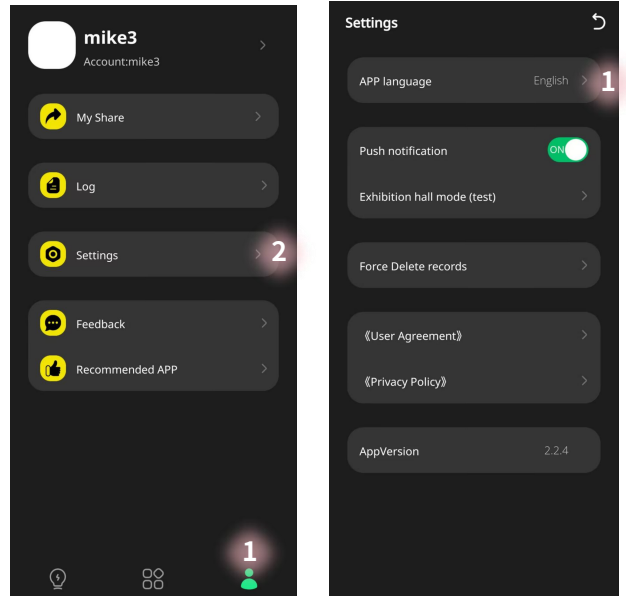

- ① Select My Page
- ② Click Settings
- ① Select Language

Wake Up The Device's Bluetooth

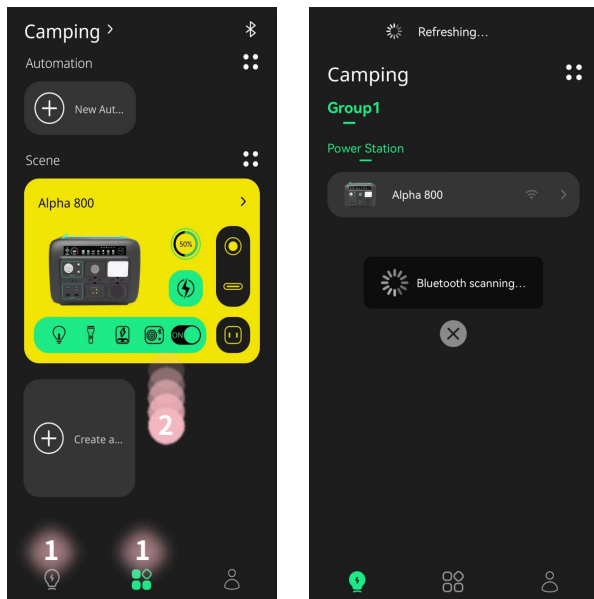

- ① Select The Device Page or Scene Page
- ② Swipe From Right to Left
- Wake Up The Device's Bluetooth

Share The Device With Others

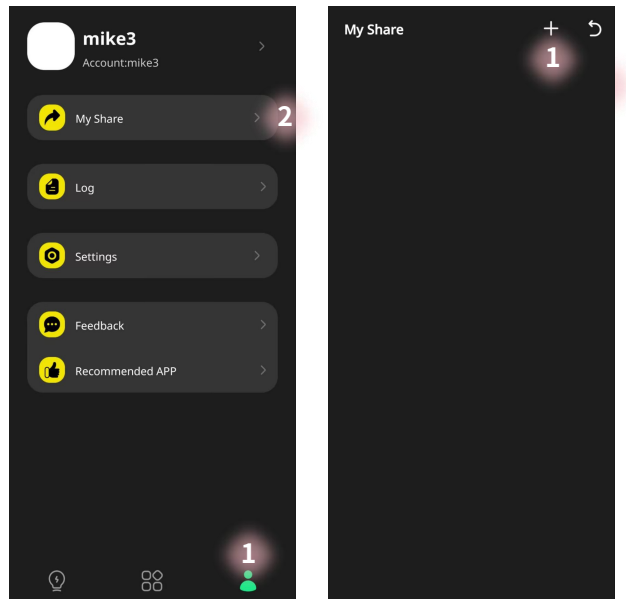

- ① Select My Page
- ② Click My Share
- ① Click+
- ② Enter someone else's account and set permissions